

Saxe Gotha Industrial Park | Speculative Building



UTILITIES

Electric	Dominion Energy	3-Phase Power Available Within Park
Natural Gas	Dominion Energy	Size of Main: 4" Distance of Main: On-Site
Water	City of Cayce	Size of Main: 10" Distance of Main: On-Site
Wastewater	City of Cayce	Size of Main: 8" Distance of Main: On-Site
Telecom	AT&T	Fiber, Voice, Internet, Cable
Fire Protection	Lexington County	Fire Insurance Rating: ISO 3

TRANSPORTATION AND ACCESS

Nearest Interstate:		
East/West	I-26	Western Boundary
Nearest Interstate:		
North/South	I-77	1 mile
Nearest Highway	I2th Street Extension	At Site
Nearest		
Commercial Airport	Columbia Metro (CAE)	9 miles
Nearest		
General Aviation Airport	LB Owens	9 miles
Nearest		
International Airport	Charlotte Douglas (CLT)	105 miles
Nearest Port	Port of Charleston	100 miles
Rail	CSX	Eastern Boundary



4838 I2TH STREET EXTENSION, WEST COLUMBIA, SC 29172

Located within the Saxe Gotha Industrial Park and inclusive to the Park's pharmaceuticals and life sciences hub, the County of Lexington's speculative building is 104,000 sq. ft. and is expandable to 195,000 sq. ft. Sitting on nearly 17 acres and accessible to I-26 and I-77, the location offers a strategic position in the heart of South Carolina with close proximity to the Port of Charleston.

Total/Available Sq. Ft.: 104,000

Expandable Sq. Ft.: up to 195,000



COUNTY of LEXINGTON
ECONOMIC DEVELOPMENT
SOUTH CAROLINA

212 SOUTH LAKE DRIVE, SUITE 502, LEXINGTON, SC 29072

803.785.6818

WWW.LEXINGTONCOUNTYUSA.COM

Saxe Gotha Industrial Park | Speculative Building



SAXE GOTHA INDUSTRIAL PARK IS HOME TO:

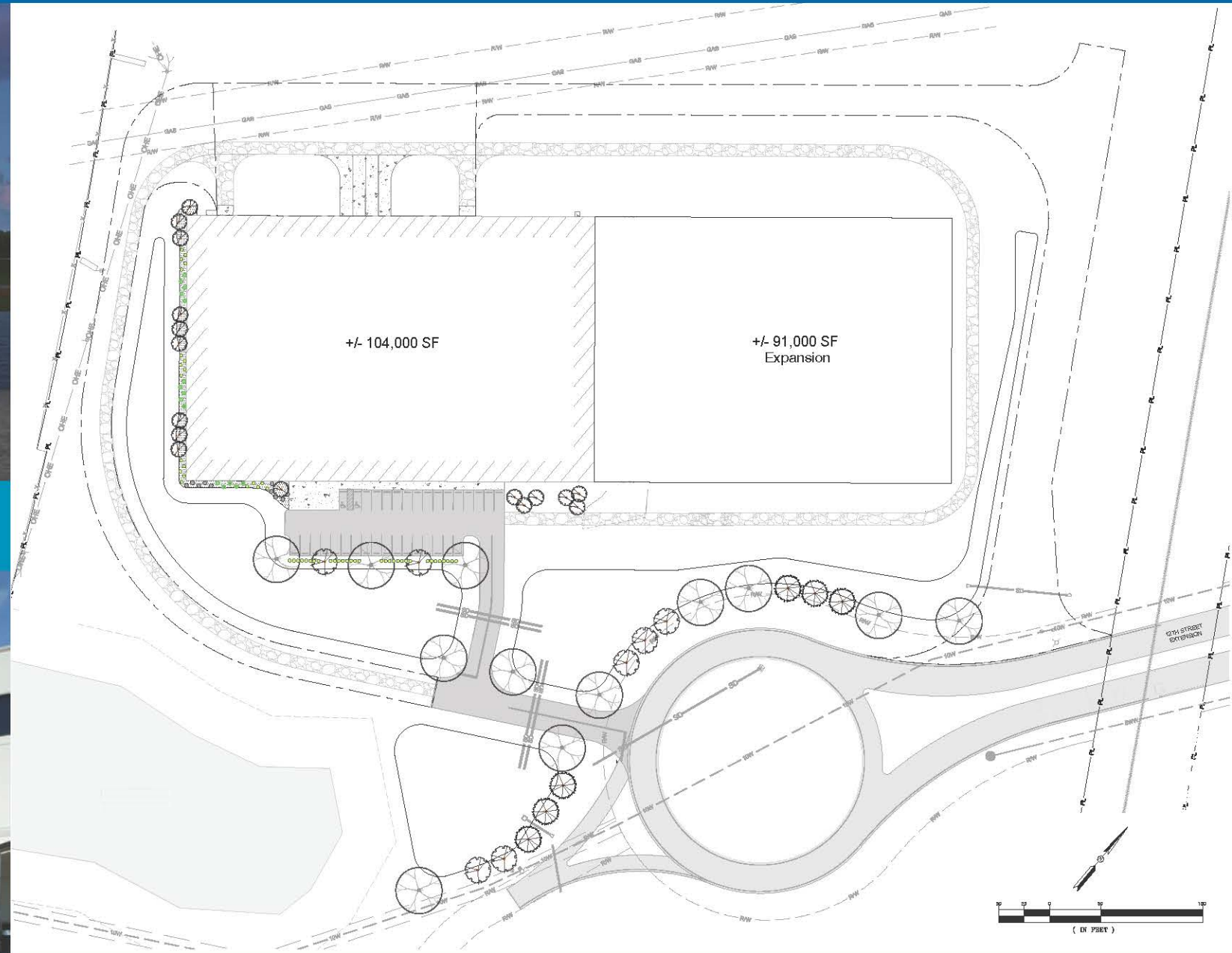
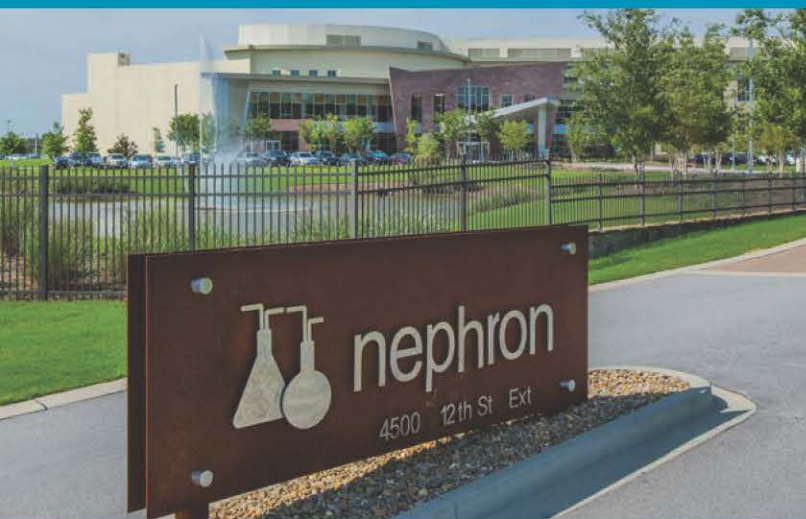

IDEAL INDUSTRY SECTORS



ADVANCED
MANUFACTURING



LIFE SCIENCES



PHARMACEUTICALS

GENERAL INFORMATION

Property Type	Industrial Building
County	Lexington
Community	Saxe Gotha Industrial Park
Latitude/Longitude	33.888304/-81.036494
Tax Map ID	008097-02-001

PHYSICAL CHARACTERISTICS

Number of Floors	One (1)
Maximum Contiguous Sq. Ft.	104,000 Sq. Ft.
First Floor Sq. Ft.	104,000 Sq. Ft.
Additional Sq. Ft.	Expandable to 195,000 Sq. Ft.
Acres	16.72
Zoning	ID (Intensive Development)
Nearby Land Use	Planned Industrial Park

SPECIAL STRUCTURES OR FEATURES

Certified Site	South Carolina Certified Site
Industrial Park Tenants	Nephron Pharmaceuticals Amazon.Com Fulfillment Center Amazon Make On Demand Dominion Energy
Year Built	2021
Clear Height (minimum)	32'
Roof	60-Mil TPO
Walls	Load-bearing Insulated Pre-Cast Panels

Floors	6" Reinforced Concrete Slab, 4,000 PSI Floor Flatness: F(F)60/F(L)40
Truck Loading	Four (4) 9' X 10' Dock Doors Two (2) 12' X 14' Dock-Doors Knock-Outs for an Additional 11 Doors
Interstate frontage	460' on I-26 .
Additional Information	Spec Building, Brand New Construction Available Spring 2021